

DECK PLAN

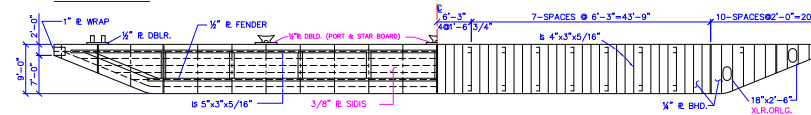

OUTBOARD PROFILE

LONGI. BULKHEAD

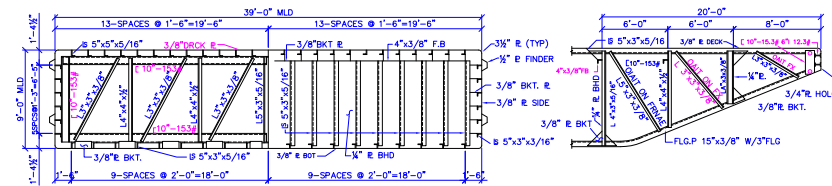

TYPICAL TRANSV. TRUSS

TYPICAL TRANSV. BHD.

TYPICAL RAKE TRUSS & FRAME

1. DECK LOAD PER SQUARE FOOT - 1000 POUNDS
2. LIGHT DRAFT 1"-4.10/16"
3. TOTAL CAPACITY AT LOAD LINE. 967.805 SHORT TONS.

ASSUMED LOAD LINE	DRAFT	SHORT TONS PER INCH IMMERSION	SALT WATER DISPLACEMENT IN SHORT TONS	CARGO DISPLACEMENT IN SHORT TONS
	9'-0"	14.560	1428.068	1241.923
	8'-6"	14.560	1335.092	1148.947
	8'-0"	14.560	1243.721	1057.576
	7'-6"	14.560	1153.950	967.805
	7'-0"	14.560	1065.792	879.647
	6'-6"	14.292	979.234	793.089
	6'-0"	14.025	894.281	708.136
	5'-6"	13.757	810.932	624.787
	5'-0"	13.490	729.188	543.043
	4'-6"	13.222	649.049	462.904
	4'-0"	12.955	570.514	384.369
	3'-6"	12.688	493.584	307.439
	3'-0"	12.420	418.258	232.113
	2'-6"	12.153	344.537	158.392
	2'-0"	11.885	272.420	86.275
	1'-6"	11.618	201.900	15.755
	1'-4.10/16	11.550	186.145	0
	1'-0"	11.350	133.000	0

ASSUMED LOAD LINE

LIGHT DRAFT



Canal Barge Company, Inc.
 835 Union Street
 New Orleans, LA 70112
 Phone 504.581.2424
www.canalbarge.com

140' x 39' x 9'-0"

DECK CARGO BARGE (OCEAN SERVICE)

GENERAL ARRANGEMENT

CMS 611-628

LEGAL NOTICE: General arrangement and other drawings are provided for informational purposes only. Canal Barge Company, Inc. does not warrant the accuracy of any drawing of any barge. By accessing and/or downloading any barge drawing, user agrees to hold harmless Canal Barge Company, Inc. from any claim or loss that may arise from the use of those drawings or any errors or omissions therein.